



GITW 2024 Program

Global Information and Telecommunication Workshop
December 20th-21st 2024 // Tokyo, Japan (Hybrid)



Dec. 20th (DAY1)

Map (Day 1)

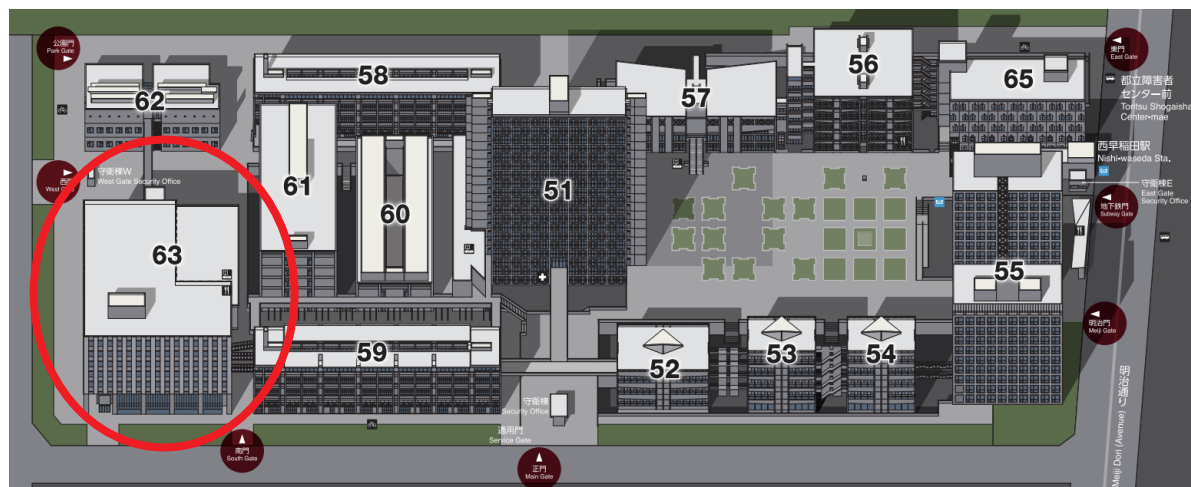

Conference Venue
Room 203/205, 2F,
Bldg. 63,
Nishi-Waseda Campus
Waseda University,
Nishi-Waseda Campus
located at 3-4-1 Okubo,
Shinjuku City, Tokyo,
JAPAN.

Presentation

Presentation time: 12min (Presentation 10min, and Discussion 2min)

For on-site participants:

If you would like to use your latest version PPT file for your presentation, please bring your USB flash drive or laptop on the venue. On the other hand, the venue PCs will contain the submitted PPT files, so you can also use the submitted PPT file for your presentation.

For online participants:

This workshop will use Zoom.

Therefore, we would like to ask you to share a screen of your PPT in your presentation.

ZOOM

Room A: Meeting ID: 944 0997 0791 Passcode:464018

Room B: Meeting ID: 990 2674 3705 Passcode:221435

If you want to play slides with embedded audio, check the "Share sound" checkbox in zoom.

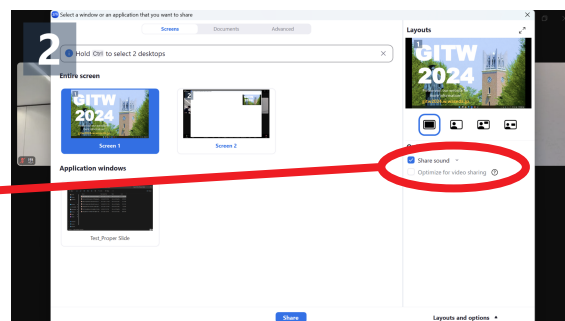

Wi-Fi

SSID: waseda-event007 Password:S6xyCH9e

On-site Lunch

Lunch boxes will be distributed at 63-204. 63-203/205 for students, 63-204 for faculties.

Reception Party

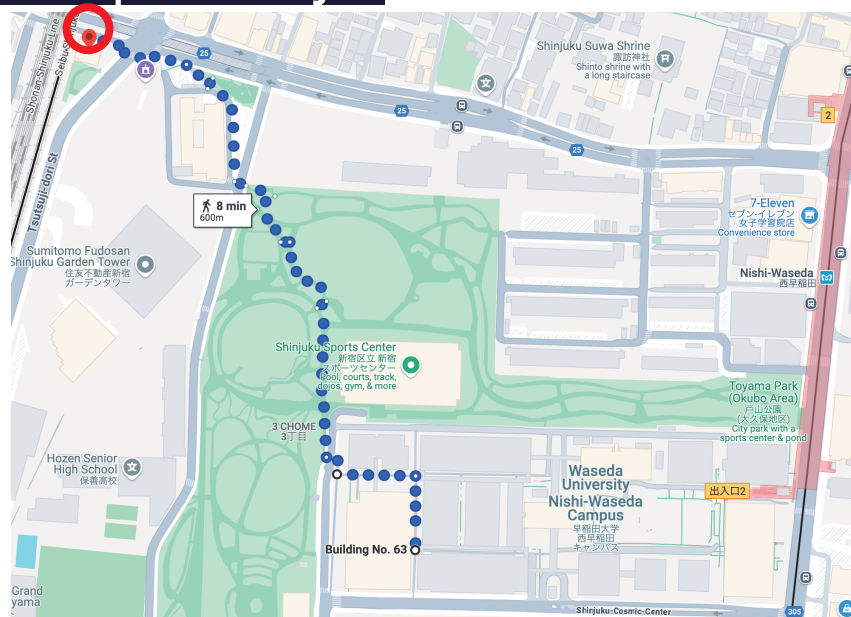

18:00-19:30

Cucina Caffe OLIVA

<https://cucina-caffe-oliva.jp>

map <https://g.co/kgs/Tqq9HxP>



| | | |
|---|--|--|
| Opening 9:00-10:45 (Bldg.63, 2F, Room 203) (Zoom Room A) | Welcome Speech | |
| | 9:00-9:05 Prof. Shigeru Shimamoto (Director of GITI, Waseda University) 9:05-9:20 Prof. Naoaki Yamanaka (President of IEICE) Group Photo Shooting 9:20-10:45 Introductions of Participant Universities (in coordination) Introduction from Co-Organizers, Prof. Mina Rho, Head of the Department of Computer Science, Hanyang University (4min) Introduction from Co-Organizers, Sheng Zhou, Head of Institute of Communications, Dept. EE, Tsinghua University (4min) Introduction from Co-Organizers, Prof. Fang-Jing Wu (National Taiwan University) (4min) | |
| | Introduction from GITW Session Universities: Shanghai Jiaotong University; Zhe Jiang University; Yangzhou University; SouthWest Jiaotong University; Institut Teknologi Sepuluh Nopember (ITS); University of Cambridge; Khalifa University; University de Lille (3min per each university) | |
| | Introduction from ASPIRE Session Universities: Keio University, University of Houston, Norwegian University of Science and Technology, Queen's University Belfast, Memorial University, Charles Sturt University, University of California, Davis (3min per each university) | |
| | Keynote Session 10:45 (Bldg.63, 2F, Room 203) (Zoom Room A) | 10:45-11:00 Globalization via Regionalization Professor ZhiSheng Niu (Tsinghua University) 11:00-11:15 Hybrid Quantum-Classical Machine Learning/Optimization for 6G Prof. Trung Q. Duong (Queen's university Belfast / Memorial University) 11:15-11:30 EarID CAN: A Novel Biometric Inspired Continuous, Active and Non-Intrusive Authentication via Acoustic Ear Scanning Prof. Miao Pan (University of Houston) |

| | |
|-------------|--|
| 11:30-13:00 | Lunch Break (63-203/205 for students, 63-204 for faculties), Lunch boxes will be distributed at 204. |
|-------------|--|

| | | | | | | |
|--------------------------|--|---------------------|--|---|---|--|
| Session 1 13:00-15:00 | GITW Session 1A (Bldg. 63-203) (ZOOM Room A) Topics 1A Wireless Communication Chair: Fang-Jing Wu ,National Taiwan University) | | | ASPIRE Session 1B (Bldg.63-205) (ZOOM Room B) Topics 1B Mobile communications, ISAC Chair: Yue Yin , KEIO University | | |
| | 1 | Md. Abir Hossain | Mawlana Bhashani Science and Technology University | B5G/6G IRS-enabled Ultra Reliable Low Latency Communication using Retransmission Mechanism and Reserved Bandwidth | Greetings from Prof. Shimamoto (Waseda Univ.) and Prof. Otsuki (Keio Univ.) | |
| | 2 | Yaodan Xu | Tsinghua University | Joint Optimization of Offloading, Batching and DVFS for Multiuser Co-Inference | Sebastian G. Groesvik | Norwegian University of Science and Technology |
| | 3 | Haowei Cheng | Waseda University | A Systematic Literature Review of Generative AI in Requirements Engineering | Nathanael DANSO-NTIAMOAH | Memorial University |
| | 4 | Ruiqing Mao | Tsinghua University | DiffCP: Ultra-Low Bit Collaborative Perception via Diffusion Model | Wei Dai | KEIO University |
| | 5 | OUCHI Hayate | Waseda University | Investigation of Ionospheric Condition Estimation and Representation Methods from a Communication Perspective | Alice Faisal | Memorial University |
| | 6 | I Putu Dody Lesmana | Institut Teknologi Sepuluh Nopember | Ensemble Stacking Deep Convolutional Neural Networks for Classification and Morphological Analysis of Mosquito Genera Based on Multi-View Larvae Images | Khin Than Htay | Waseda University |
| | 7 | Zhuolong Li | SouthWest Jiaotong University | Research on Wide-Area Mobile Target Tracking and Positioning in Complex Electromagnetic Environments | Aseni Chamandika Jayarathne | Memorial University |
| | 8 | Shazana Dhiya Ayuni | Institut Teknologi Sepuluh Nopember | Design and Analysis of a 2.45 GHz Rectenna for Maximizing Wireless Power Transfer Efficiency | Mondher BOUAZIZ | KEIO University |

| | |
|-------------|------------------------|
| 15:00-15:30 | Session break (30 min) |
|-------------|------------------------|

| | | | | | | |
|--------------------------|--|--------------------|-------------------------------------|---|------------------|--|
| Session 2 15:30-17:30 | GITW Session 2A (Bldg.63-203) (ZOOM Room A) Topics 2A Digital Contents, Communication Chair: Sheng Zhou, Tsinghua University | | | ASPIRE Session 2B (Bldg.63-205) (ZOOM Room B) Topics 2B Non-terrestrial communications Chair: Tu Dac Ho, Norwegian University of Science and Technology | | |
| | 1 | Jiaqian XIE | WASEDA Univeristy | Scaled Weight-Sharing Convolutional Network for Memory-Efficient Video Frame Prediction | Thomas Zinner | Norwegian University of Science and Technology |
| | 2 | Yi-Chia CHEN | National Taiwan University | Combining Present-Only and Present-Absent Data with Pseudo-Label Generation for Species Distribution Modeling | Riku NAGASE | KEIO University |
| | 3 | Mohamad Zaki Azizi | Institut Teknologi Sepuluh Nopember | Driving Innovation: The Role of Digital Transformational Capability and Organizational Ambidexterity in the Automotive Components Industry | Kazutoshi Yoshii | Waseda University |
| | 4 | Dingjie PENG | WASEDA Univeristy | Waveformer: Innovative Token Mixing for Plug-and-Play Image Restoration | Yue Yin | KEIO University |
| | 5 | Mohammad Rahman | Federation University Australia | Enhancing Soil Organic Carbon Estimation Using Sequential Band Selection with 1D-CNN | Sicong Li | Waseda University |
| | 6 | Usama Khalid | Hanyang University, Seoul | Real-Time Biometric Obfuscation for Enhanced Digital Privacy using YOLOv8n and U-Net | Siyuan Yang | KEIO University |
| | 7 | | | | IAHMED AL-HABOB | Memorial University |
| | 8 | Dony Hutabarat | Institut Teknologi Sepuluh Nopember | A CNN-Based Obstacle Avoidance System for Electric Wheelchairs Using LiDAR and Thermal Camera | Selma Yahia | University de Lille |

| | |
|---------------------|---------------------|
| Online presentation | Onsite presentation |
|---------------------|---------------------|

| | |
|-------------|--|
| 18:00-19:30 | Reception party (Cucina Caffè OLIVA, https://cucina-caffe-oliva.jp , map: https://g.co/kgs/Tqq9HxP), |
|-------------|--|

Dec. 21st (DAY2)

Map (Day 2)

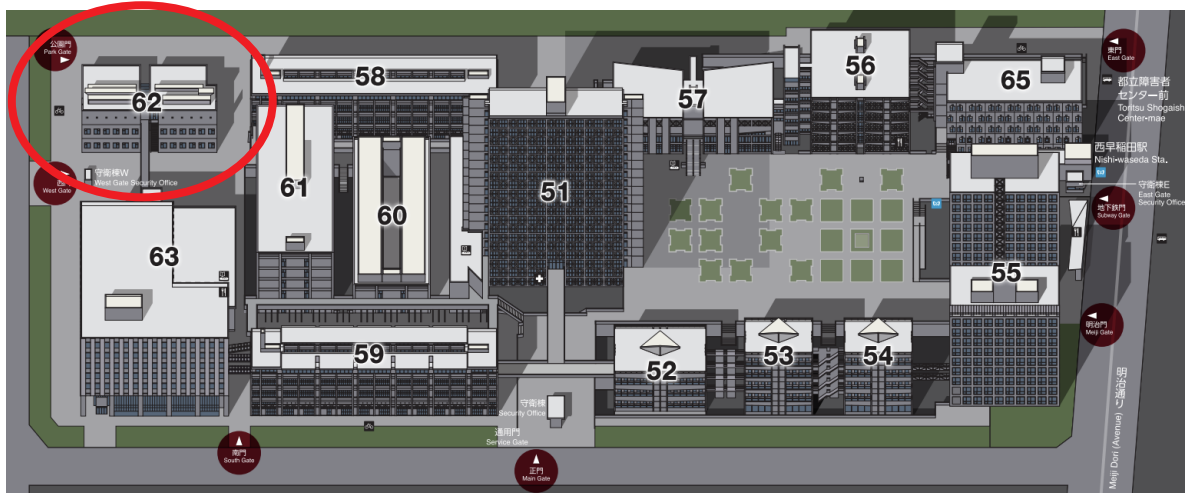

Conference Venue
Room A and B, 1F,
Bldg. 62
Nishi-Waseda Campus
Waseda University,
Nishi-Waseda Campus
located at 3-4-1 Okubo,
Shinjuku City, Tokyo,
JAPAN.

Presentation

Presentation time: 12min (Presentation 10min, and Discussion 2min)

For on-site participants:

If you would like to use your latest version PPT file for your presentation, please bring your USB flash drive or laptop on the venue. On the other hand, the venue PCs will contain the submitted PPT files, so you can also use the submitted PPT file for your presentation.

For online participants:

This workshop will use Zoom.

Therefore, we would like to ask you to share a screen of your PPT in your presentation.

ZOOM

Room A: Meeting ID: 944 0997 0791 Passcode:464018

Room B: Meeting ID: 990 2674 3705 Passcode:221435

If you want to play slides with embedded audio, check the "Share sound" checkbox in zoom.

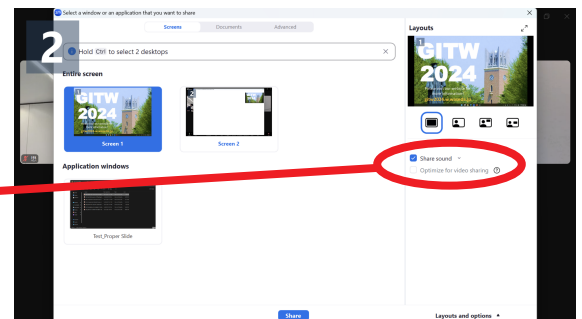

Wi-Fi

SSID: waseda-event007 Password:S6xych9e

On-site Lunch

62-RoomA for students, 62w 1st floor "Morimura memorial lounge" for faculties), Lunch boxes will be distributed front of RoomA

Dinner and Awards Ceremony

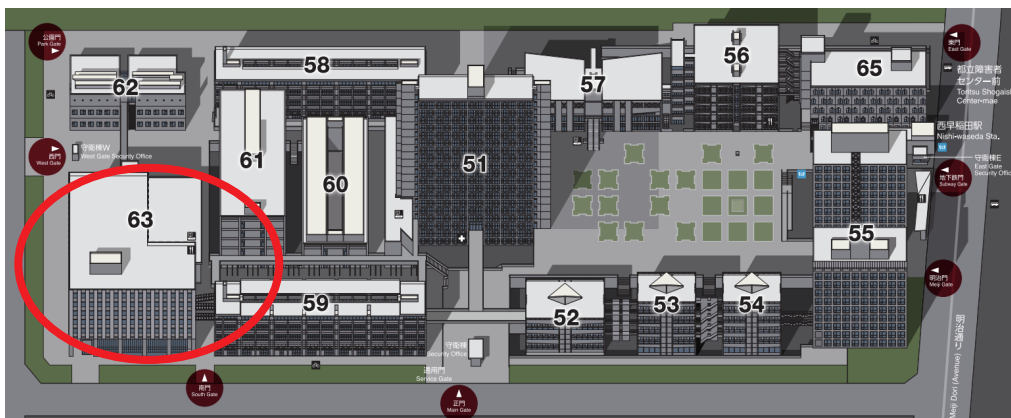

16:30-18:30
Rohm Square, 1F Bldg. 63,
Nishi-Waseda Campus



| Session 3 9:30-11:30 | GITW Session 3A (Bldg. 62-Large Meeting room A) (ZOOM Room A) Topics: IoT Sensor, AI Chair: Toshitaka Tsuda , Waseda University | | | | ASPIRE Session 3B (Bldg. 62-Large Meeting room B) (ZOOM Room B) Topics 1B Security and AI, Vehicular network Chair: Zhenni Pan, Waseda University | | |
|-------------------------|---|-------------------------|--|--|---|--------------------------|---|
| | 1 | Windi Eka Yulia RETNANI | Institut Teknologi Sepuluh Nopember | Augmenting Code Smell Using Generative Adversarial Network As a Mean To Solve Imbalance Dataset | Quazi Mamun | Charles Sturt University | The Internet of Behavior (IoB): Transforming Human Interaction in the Digital Age |
| | 2 | Joko Supriyono | ITS (Institut Teknologi Sepuluh Nopember) Indonesia | TE-LSTM: Enhancing Maintenance Strategy from Winding Temperature Prediction for Induction Motors in the Oil and Gas Industry | Abdulmohsen Alsai | Memorial University | When are Quantum Algorithms Applicable for Signal Decoding in Wireless Communication? |
| | 3 | Zecheng Li | Zhejiang University | Point Cloud Generation Method for 3D Perception using Monocular Images and Radar | Muhammad Rana | Charles Sturt University | Securing IoT Networks: A Lightweight Cryptographic Solution for Society 5.0 |
| | 4 | JIN Yuxuan | Waseda University | Non-Contact Monitoring of Physiological Parameters Using Wi-Fi Frequency Bands | Megumi Saito | Waseda University | D2D Transmission Scheme in Emergency Situation for Mobile Networks |
| | 5 | Heyi Zhang | Shanghai Jiao Tong University | BDPL: Toward Byzantine-resilient and Privacy-preserving Distributed Learning | Md Mujibur Rahman | Charles Sturt University | Federated Learning for Secure Spatial Crowdsourcing by Leveraging 6G Communication Technology |
| | 6 | Kazuma Uesugi | Waseda University | Comparison of Simulation and Experimental Results in OAM Multiplexing with Misalignment-Induced Degradation | Huan Wang | Waseda University | Effects of Driving Behavior-Oriented On-street Parking Schemes on Traffic Efficiency within Urban Road Networks |
| | 7 | Minseo KIM | HANYANG University | Compositional Video Understanding with Spatiotemporal Structure-based Transformers | Md Ershadul Haque | Charles Sturt University | Novel quantum circuit for image compression utilizing block partitioning and zero connection discarded approach |
| | 8 | AHMED AL-HABOB | Memorial University of Newfoundland | Network Slicing for Unmanned Aerial Vehicle Networks | Yuki Uetake | Waseda University | Analysis of V2X Communication Performance through the Implementation of Fixed Assignment Window Access with Diversity and SIC |
| 11:30-13:00 | Lunch Break (62-RoomA for students, 62w 1st floor “Morimura memorial lounge” for faculties), Lunch boxes will be distributed front of RoomA | | | | | | |

| Session 4 13:00-14:30 | GITW Session 4A (Bldg. 62-Large Meeting room A) (ZOOM Room A) Topics: Machine Learning and AI Chair: Wu Jun , Waseda University | | | | ASPIRE Session 4B (Bldg. 62-Large Meeting room A) (ZOOM Room B) Topics 1B Image Processing, Healthcare, Security Chair: Quazi Mamun, Charles Sturt University | | |
|--------------------------|--|-------------------------------|--|---|---|------------------------------|---|
| | 1 | Hyeonseok An | Hanyang university | DeCo-YOLOs: Deformable Convolution | Hiroshi Katada | Waseda University | Performance Analysis of Bio-inspired Load Balancing Routing for Wireless Multi-hop Network |
| | 2 | Rahmatika Jagad Pramundito | Institut Teknologi Sepuluh Nopember | Development of a System Dynamics Model for Policy Formulation on Investment Feasibility in Corn Land Intensification in East Java | Md Mehedi Hasan | Charles Sturt University | Adaptive Adversarial Attack and Defence Algorithm for Network Intrusion Detection Systems (A3D-NIDS) |
| | 3 | Hyeonmin Mo | HANYANG University | RCFuzzer: Reinforcement learning-based Collaborative Fuzzer | Joy Dutta | Khalifa University | Transforming Future Healthcare with IoMT and Edge Computing: An Ethical and Transparent Approach to Predictive eHealth |
| | 4 | Tegar Ganang Satrio Priambodo | Sepuluh Nopember Institute of Technology (ITS) | Ensemble-based Fraud Detection with Imbalanced Data of Indonesian Administrative Health-Records | Faranak TOHIDI | Charles Sturt University | Efficient Dynamic Point Cloud Compression Through Adaptive Hierarchical Partitioning |
| | 5 | Mao WANG | WASEDA University | Real-Time Data Fusion for PD-ISAC based on Zadoff-Chu OFDM | Hossien Eldeeb | University of Cambridge | Toward Advanced eHealth with Explainable AI: Blockchain-Secured Systems Featuring AI-Driven Block Sensitivity for Adaptive Authentication |
| | 6 | Mohammad Ovi Sanjaya | Institut Teknologi Sepuluh Nopember | Conv1D-BiLSTM: A Deep Learning-Based Multivariate Model for Multi-Step Stock Index Forecasting | Liu Chenyang | Waseda University | A Study of Pathological Symptoms Detection Employing Voice Analysis towards Daily Healthcare |
| 14:30-15:00 | Session break (30min) | | | | | | |
| Session 5 15:00-16:00 | GITW Session 5A (Bldg. 62-Large Meeting room A) (ZOOM Room A) Topics: Wireless Communication and AI Chair: Dong-Kyu Chae, Hanyang University | | | | GITW Session 5B (Bldg. 62-Large Meeting room B) (ZOOM Room B) Topics: Vehicular System and Autonomous Driving Chair: Jiang Liu, Waseda University | | |
| | 1 | Keita IZAWA | WASEDA University | A Consideration on Applying Fine-tuning to Subjective Evaluation Estimation of Videos to Reduce Subjects' Loads | Tan Chen | Tsinghua University | Mobility Accelerates Learning: Convergence Analysis on Hierarchical Federated Learning in Vehicular Networks |
| | 2 | Ruel En Liang | National Taiwan University | Semi-Supervised Learning for Stomata Detection | Mu Wang | Yangzhou University | An Efficient Cooperative Driving Scheme for Emergency Vehicle Priority through V2X Communications |
| | 3 | Ke ZHANG | WASEDA Univeristy | 3PS: Periodic Partial Policy Sharing for Distributed Cooperative Multi-agent Reinforcement Learning | Yilun Hu | Shanghai Jiaotong University | Artificial Intelligence Empowered Generalizable Personalized Traffic Detection Against Advanced Persistent Threats |
| | 4 | chengdi jiang | Yangzhou University | An Efficient and Safe Cooperative Driving Strategy to Solve Road Deadlocks through V2V Communication | Simon Choi | Waseda University | Constructing IoT Networks using a Microbial Fuel Cell |

| | |
|---------------------|---------------------|
| Online presentation | Onsite presentation |
|---------------------|---------------------|

| | |
|-------------|---|
| 16:30-18:30 | Award Ceremony & Banquet (Rohm Square, 1F Bldg. 63, Nishi-Waseda Campus) |
|-------------|---|